



# Spec Sheet: Pressure Gauge with Gas Mount (PGGM)

## Models

- PG15GM (Counts in 5's)
- PG30GM (Counts in 5's)
- PG60GM (Counts in 10's)

## Application

- Utility gas test gauge with horizontal housing
- For pressure tests of residential and commercial piping system

## Specifications

- Dial Size: 2" (50mm)
- Case: Black Steel
- Wetted Parts: Copper Alloy
- Bezel: Black Steel
- Lens: Glass Window
- Socket and Connection: Copper Alloy
- Movement: Copper Alloy
- Bourdon Tube: Brass
- Pointer and Dial: Aluminum Finish
- Connection: top mount  
3/4" female x 1/4" female gas mount unit
- Scale: Single Scale PSI
- Accuracy: 3-2-3% of Span, ASME Grade B
- Ambient Temperature: -20-60C

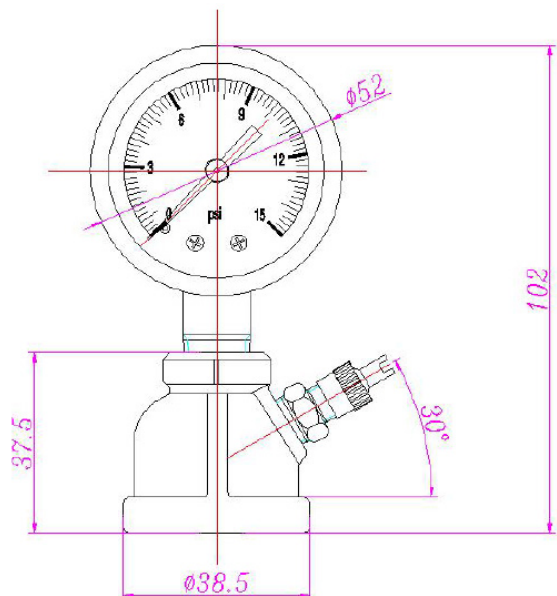
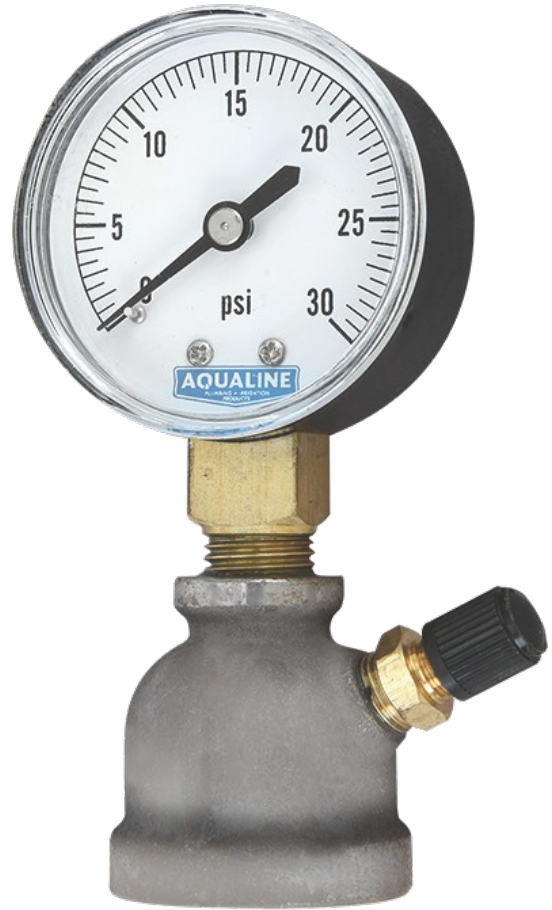

**WARNING:** This product can expose you to chemicals including Lead, which are known to the State of California to cause cancer and birth defects or other reproductive harm. For more information go to:  
[www.P65Warnings.ca.gov](http://www.P65Warnings.ca.gov)  
Wash hands after handling.