



Spec Sheet: 1" Brass Full-Circle Impact Sprinkler (I100)

Features

- 25° trajectory
- Double opposing side nozzles
- Full circle coverage
- Stainless steel parts
- Diffuser pin assembly

Operating Range

- Pressure 40-80 PSI
- GPM 15-49
- Spacing 57'-80'
- Highest point of stream - 9ft. above nozzle level

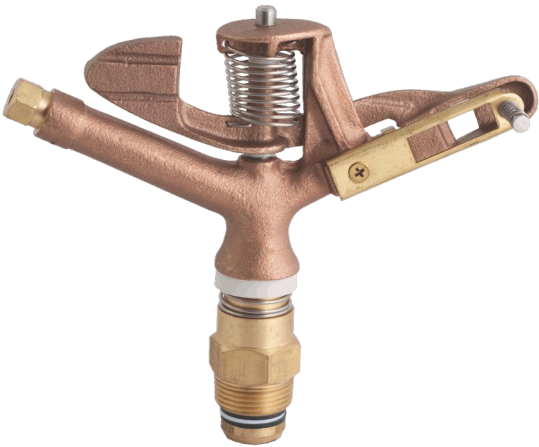

Specifications

Nozzle	1/4" X 5/32"		1/4" X 3/16"	
	RADIUS	GPM	RADIUS	GPM
40	60	17.8	60	20.1
45	61	18.9	61	21.3
50	61	20.1	61	22.5
55	62	21.2	62	23.6
60	63	22.2	63	24.7
65	64	23.0	64	25.8
70	65	23.8	65	26.8
75	66	24.6	66	27.8
80	66	25.4	66	28.8

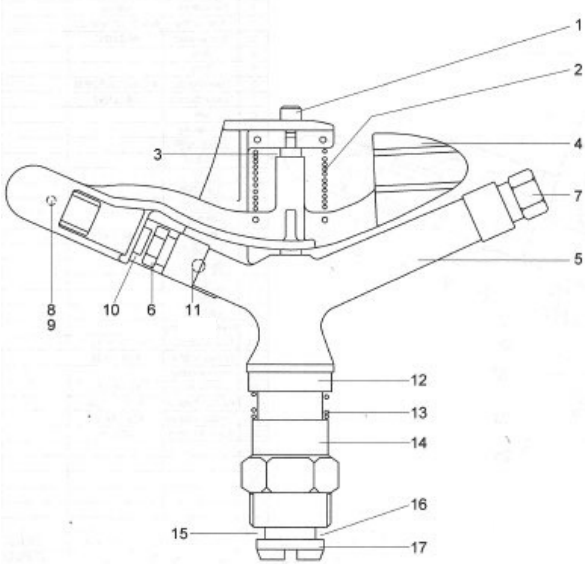

No.	Parts	No.	Parts
1	Fulcrum Pin	10	Pin Assembly
2	Arm Spring	11	Pin Bolt
3	Arm Washer	12	Spring Cap
4	Arm	13	Pressure Spring
5	Body	14	Sleeve Assembly
6	Nozzle	15	Washer Rubber
7	Back Nozzle	16	Thrust Washer
8	Pin	17	Bearing Nipple
9	Pin Spring		

